

DUAL CEV-12000 DLB-925 12" MEDIA EVAP COOLER w/RAIL & DD-2

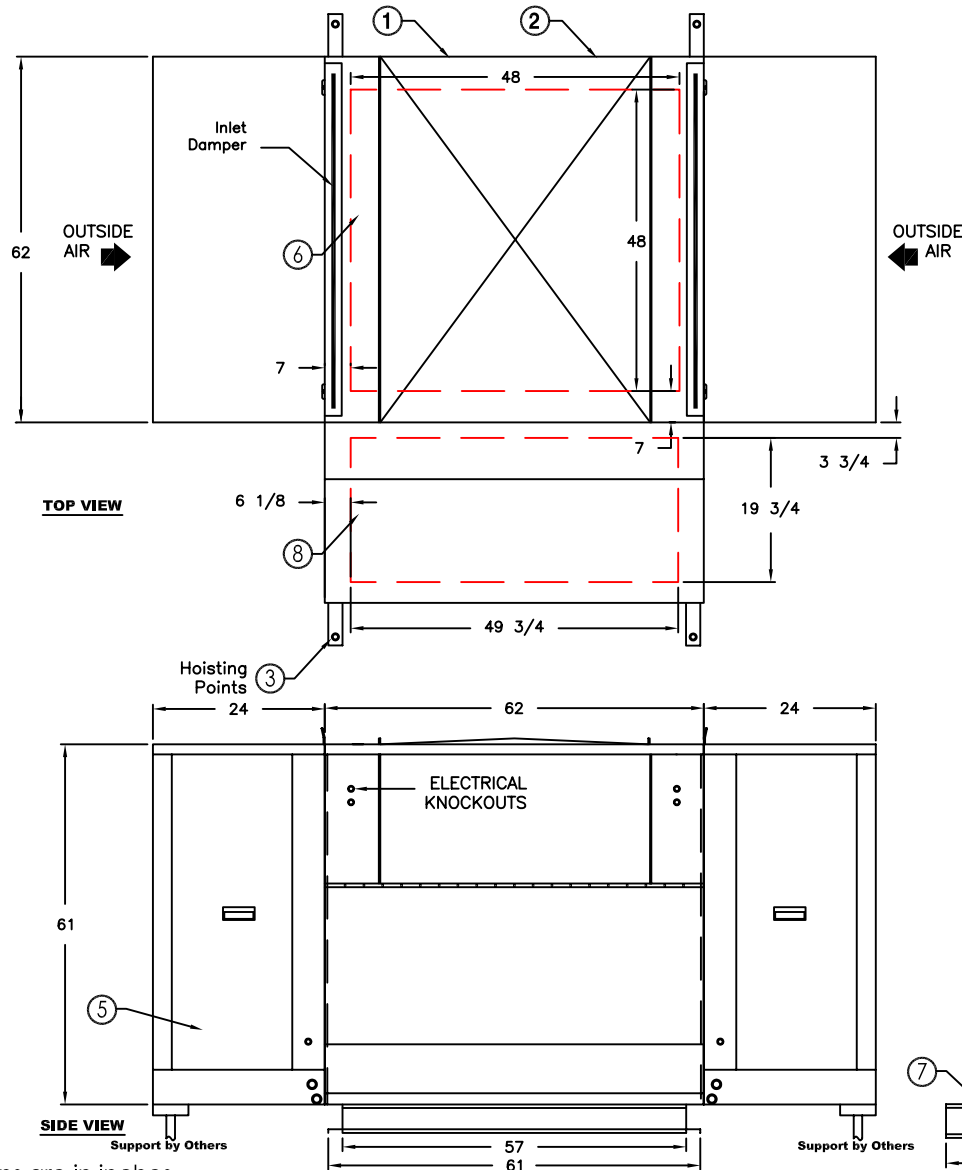

NOTES:

- ① DLB-925 Constructed of 18 Ga. G90. Galvanized Finish. Unit shown with (2) all S.S. CEV-12,000 Evaporative Cooler attached.
- ② Solid Blower & Motor Access Panels on back side of dual blower.
- ③ Hoisting Points are a part of the Unit Mounting Rails and are not intended for use in suspending units. Contact factory for unit suspending information. In addition, hoisting eyes will shipped loose for additional support.
- ④ Unit provided with Stainless Steel expanded metal bird screen and (9) 18"x 20"x2" 30% pre-filter on inlet air standard.
- ⑤ (2) CEV-12000 12" Media Evaporative cooler 304 18 ga. Stainless Steel construction. Unit shipped separately.
- ⑥ Optional Return Air opening shown. Return Air Opening is 48" x 48". Return Air option includes (9) 16"x16 x1" T/A Filter as standard. R/A Max CFM is 10,400cfm.
- ⑦ Full perimeter rail 8 to 12 GA, G90, Galvanized finish with 6" lifting extensions. NOT intended for suspending unit, contact factory.
- ⑧ Optional Down Discharge opening shown. Down Discharge Opening is 46 3/4" x 19 3/4".

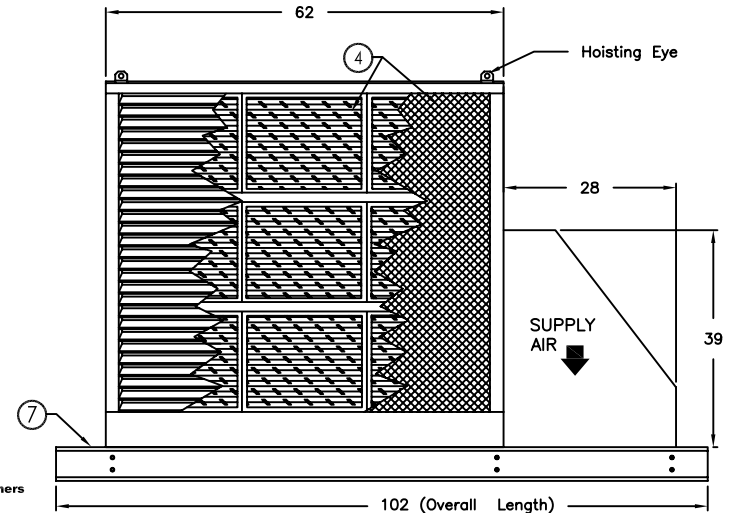

APPROX.
NET WEIGHT:
1650 lbs.

NOTE: All dimensions are in inches.

PROJECT:	LOCATION:	
ENGINEER:	ARCHITECT:	
CONTRACTOR:	DATE:	PAGE: _____ of _____

ARES

A Division of Mars[®] Air Products
 14716 S. BROADWAY ♦ GARDENA, CA 90248
 Phone: (310) 532-1555 ♦ (800) 421-1266 ♦ Fax: (310) 324-3030
 WEB SITE: www.marsair.com ♦ E-MAIL: aresinfo@marsair.com